



***A NEW HOME –  
A... NEW BEGINNING !***



**YES – WE ARE MOVING FROM THE PALM COURT**



**TO - A SPLENDID NEW FACILITY – AB10 7GJ**



**MORE SPACE – MORE TECHNOLOGY !**

## ICORR ABERDEEN BRANCH 2018/2019 PROGRAMME OF EVENTS

REV 3, 07/09/2018

Date	Event Type	Speaker / Company	Topic	Time	Venue
Tuesday 14/08/2018	2018 Corrosion Awareness Day (CAD)	EMERSON - Key Sponsor	Wide Range of Corrosion Topics and Equipment Demonstrations from the Aberdeen Corrosion Awareness Team	Event to start at 09:00 and finish at 16:00	Emerson Solutions Centre, 1 Harvest Avenue, D2 Business Park, Dyce, Aberdeen AB21 0BQ
Tuesday 25/09/2018	Joint Meeting with TWI	Michael Young and Neil Gallon of Rosen Group	Preferential Weld Corrosion (PWC) for Subsea and Topsides Systems	Sign in & Network from 17:45; Complementary Buffet from 18:00; Presentation at 18:30.	Room N242, Sir Ian Wood Building, Robert Gordon University (RGU), Garthdee Road, Aberdeen AB10 7GJ
Tuesday 30/10/2018	ICorr Technical Event	Chris Burke of Emerson - Permasense	Optimising Plant Integrity and Solids Control through continuous Non-Intrusive Wall Thickness Monitoring	Sign in & Network from 17:45; Complementary Buffet from 18:00; Presentation at 18:30.	Room N242, Sir Ian Wood Building, Robert Gordon University (RGU), Garthdee Road, Aberdeen AB10 7GJ
Tuesday 27/11/2018	Joint ICorr/IOM3 Event	Ed Wade of Metal Ecosse	Downhole Metallurgy and Corrosion Control	Sign in & Network from 17:45; Complementary Buffet from 18:00; Presentation at 18:30.	Room N242, Sir Ian Wood Building, Robert Gordon University (RGU), Garthdee Road, Aberdeen AB10 7GJ
Tuesday 29/01/2019	ICorr Technical Event	Paul McCarthy of Plant Integrity Management (PIM)	Integrity Issues and Planned Production Losses – How to Break the Cycle	Sign in & Network from 17:45; Complementary Buffet from 18:00; Presentation at 18:30.	Room N242, Sir Ian Wood Building, Robert Gordon University (RGU), Garthdee Road, Aberdeen AB10 7GJ

Date	Event Type	Speaker / Company	Topic	Time	Venue
Tuesday 26/02/2019	ICorr Coating Technical Event	George Sykes of International Paint	A Novel Approach to Combatting CUI	Sign in & Network from 17:45; Complementary Buffet from 18:00; Presentation at 18:30.	Room N242, Sir Ian Wood Building, Robert Gordon University (RGU), Garthdee Road, Aberdeen AB10 7GJ
		Michael Baraky (RMB Products) and Rob Mackie (United Pipeline Systems)	MIC-Resistant HDPE Linings for Seawater Applications		
Tuesday 26/03/2019	Industrial Visit	ICR	Combined Capabilities from All Five Business Units: Walker Technical, NECE, CIU, Quickflange and MOSS.	Event to start at 18:00; Visit to start at 18:30	Aberdeen Energy Park, Claymore Dr, Bridge of Don, Aberdeen AB23 8GW
Tuesday 30/04/2019	Joint ICorr/MCF Event	Dr. Ian Carpenter of Scaled Solutions	Corrosion Inhibitor Screening: Impact of Test Approaches	Sign in & Network from 17:45; Complementary Buffet from 18:00; Presentation at 18:30.	Room N242, Sir Ian Wood Building, Robert Gordon University (RGU), Garthdee Road, Aberdeen AB10 7GJ
Tuesday 28/05/2019	Joint ICorr/NACE Technical Event	AIS Training	NACE Presentation and Demo	Event to start at 18:00; Presentation to start at 18:30	3, Commercial Park, Venture Dr, Westhill, Aberdeen, AB32 6FQ
		Simon Daly of Hempel	Evaluating the Effect of Surface Preparation Standard on Zinc Rich Epoxy Primers		

### ICORR ABERDEEN BRANCH SPONSORS



**ICORR GOLD SPONSORS** - Corpro Companies Europe Ltd, Pipeline Technique, Pittsburgh Corning.

**ICORR SUSTAINING SPONSORS** - CAN Offshore, Denholm Industrial Services Ltd, Element Material Technology, ICR, Lake Chemicals & Minerals Ltd, Lux Assure Ltd, Oceaneering, Plant Integrity Management, PMAC Systems, Presserv Ltd, R&R Corrosion Ltd., Sonomatic Limited, Spencer Coatings.

# How – To Find Us - (WE ARE AT THEATRE N242)

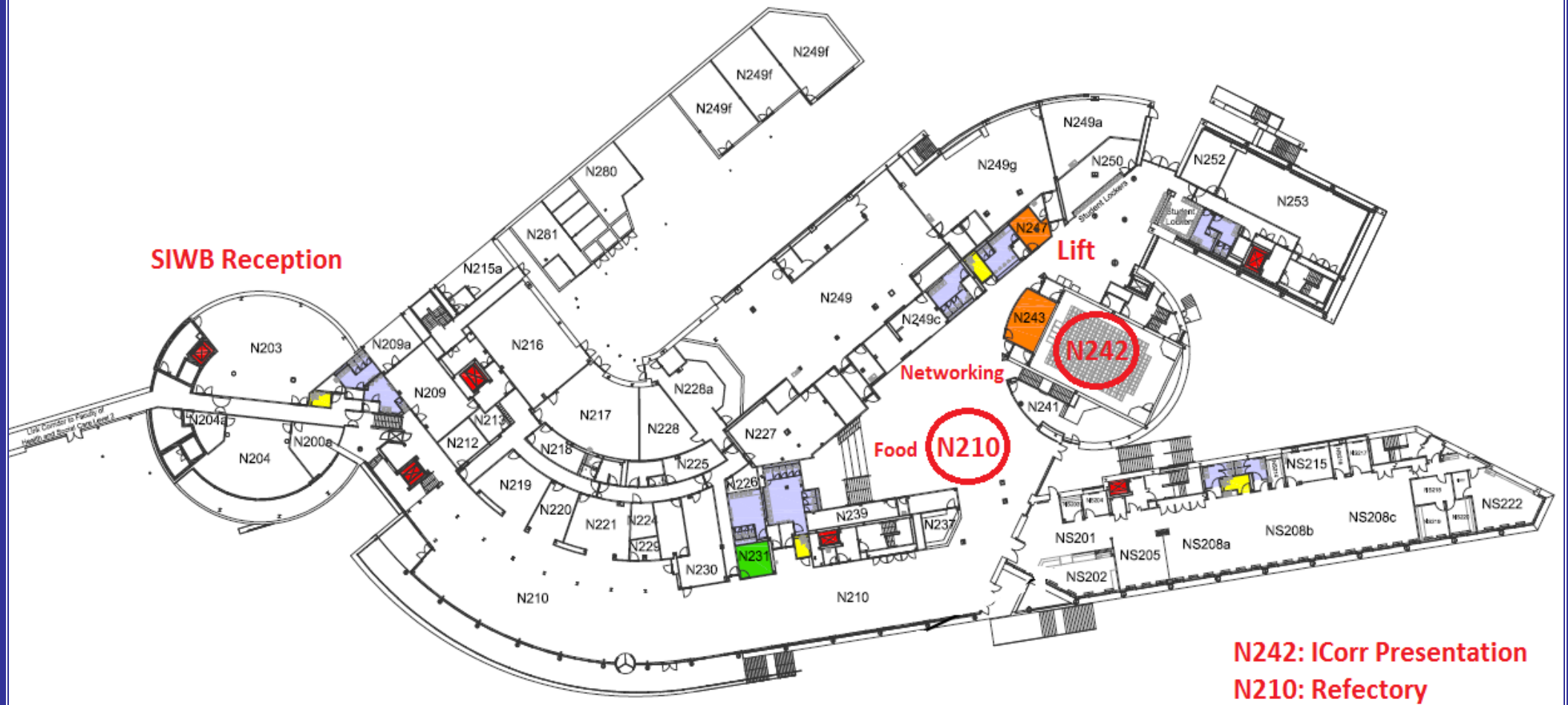

## How – To FIND Us, (SAT NAV - AB10 7GJ)

# GARTHDEE CAMPUS MAP

**GARTHDEE ROAD, ABERDEEN, AB10 7QB**



**UNIVERSITY MAIN SWITCHBOARD**  
+44 (0)1224 262000

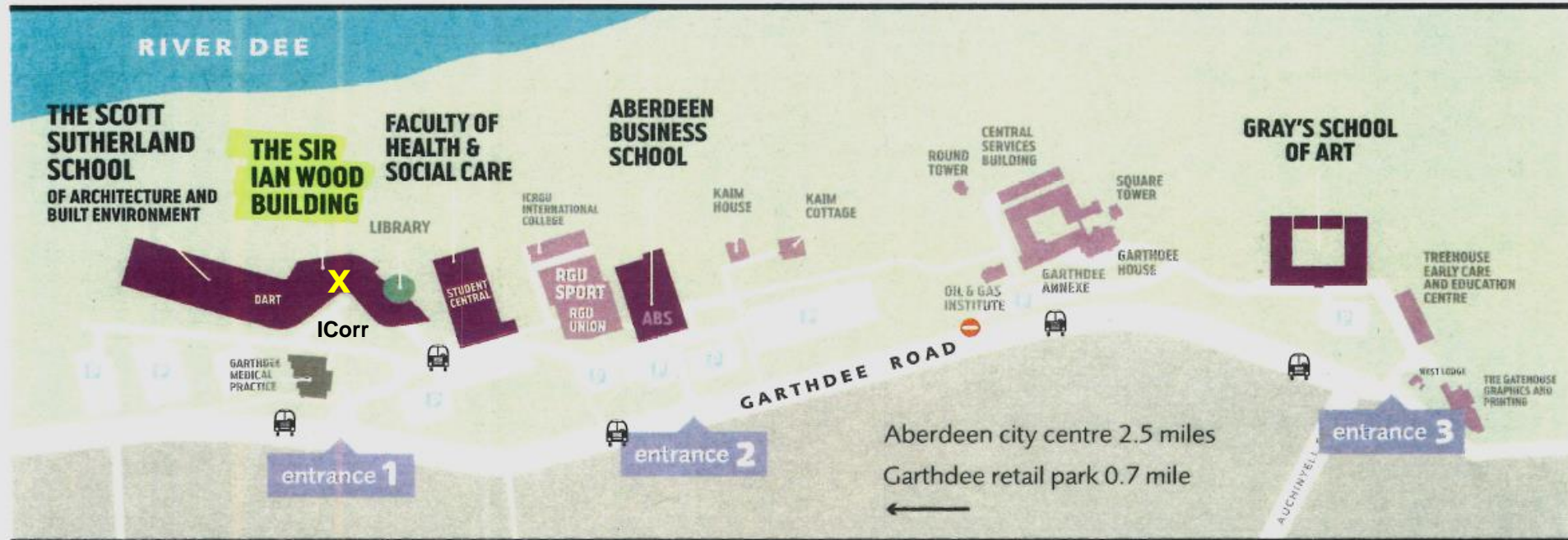

The Garthdee campus is situated on the south side of the city, on the banks of the River Dee.

Regular buses run to and from the Garthdee campus.  
For more information, go to [www.rgu.ac.uk/transport](http://www.rgu.ac.uk/transport)

There are cycle parking and changing facilities across the Garthdee campus.

### **SAT NAV POSTCODES**

Gray's School of Art	AB10 7QD
Garthdee House	AB10 7QB
Aberdeen Business School	AB10 7QE
Faculty of Health and Social Care	AB10 7QC
<b>The Sir Ian Wood Building</b> For Engineering, Computing, Pharmacy & Life Sciences and The Scott Sutherland School of Architecture and Built Environment	<b>AB10 7GJ</b>

### **CAN'T MAKE IT IN PERSON?**

 **TAKE A TOUR OF THE CAMPUS AT**  
[WWW.RGU.AC.UK/VIRTUALTOURS](http://WWW.RGU.AC.UK/VIRTUALTOURS)

YOU CAN WALK ACROSS THE ENTIRE CAMPUS  
IN AROUND 10-15 MINUTES.